

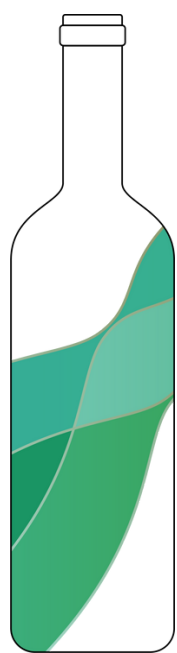



250ml Antique Green Straight Bordeaux Bottle #200

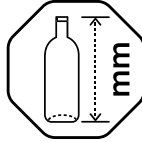
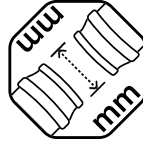
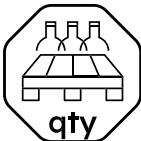

			
Capacity 250ml	Bottle Diameter 56mm	Bottle Height 200mm	Crown Diameter 24.41mm
			
Qty. per Pallet 4356	Bottle Weight 200g	Max. Pallet per 40HQ 21	Pallet Weight 900 kg

MOQ for bottle in stock : 1x40 feet Container of mixed reference
MOQ for customized wine bottles: 80,000 bottles* (we can lower to 1x40' HQ, price adjustment applies)

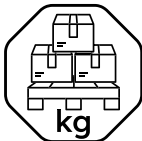
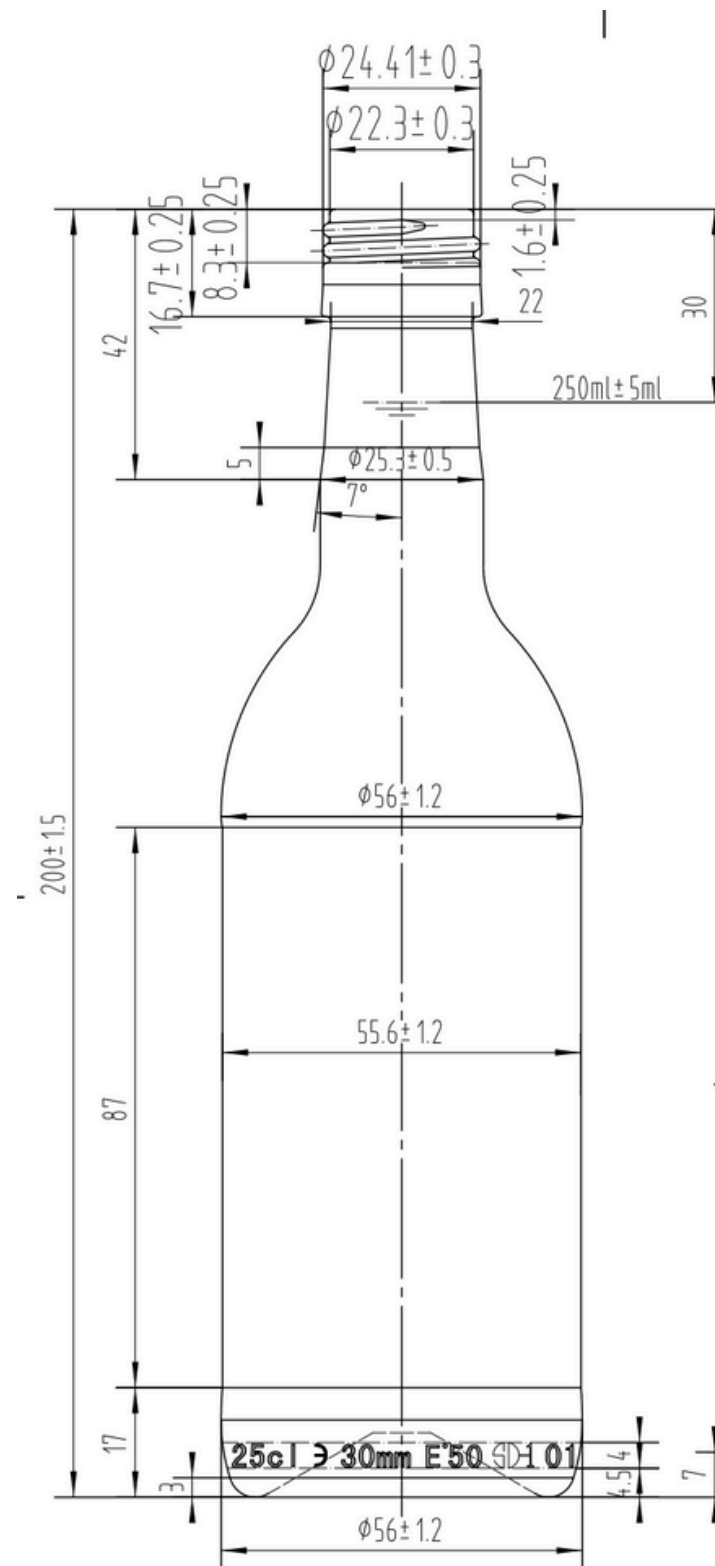

Customized bottles

Need to emboss your logo or a tailor made shape ?

Mold opening cost :

- Single-set mold : **\$4,500**
- Double-set mold : **\$7,000**

Price including samples and international delivery.

Our mold opening costs and MOQ are on average **five times lower** than those of Western manufacturers.

We can also provide you with **corks, caps, labels** and, **shrinking film** to personalize your bottle.

ISO 9001 Certified Glass Bottles Manufacturer

GlassRock is a world specialist in manufacture & customization of glass bottles. Every day, we produce glass packaging for global & local partnered brands, helping them to pack and commercialize food and beverage products with healthy, attractive, and sustainable glass packaging.